

# KOREA KYEONGWI ELECTRONICS

## DC-DC CONVERTER AR10S-2805

### Features

- Isolated DC to DC converter
- Input voltage : 18 Vdc to 36 Vdc
- Output : +5 Vdc/2 A & +7.5 Vdc/150 mA
- Size : 34.0(W)×20.0(D)×12.5(H), mm

### 1. Absolute Maximum Ratings

Parameter	Symbol	Minimum	Maximum	Unit
Input voltage range	$V_{IN}$	-0.3	+50	Vdc

### 2. Electrical Specification

Parameter	Symbol	Minimum	Maximum	Unit	
Input voltage range	$V_{IN}$	+18.0	+36.0	Vdc	
Output Voltage	+5Vdc	Vo1	+4.9	+5.1	Vdc
	+7.5Vdc	Vo2	+6.0	+9.0	Vdc
Output Current	+5Vdc(Vin=18-36Vdc)	Io1	0	2.0	A
	+7.5Vdc(Vin=18-36Vdc)	Io2	0	0.15	A
Ripple	@28V_in, 2A Load	+5V		100	mVp-p
		+7.5V		100	mVp-p
Efficiency	≥ 75 % @ full rated load current				

# KOREA KYEONGWI ELECTRONICS

DC-DC CONVERTER AR10S-2805

## 3. Common Specification

Temperature ranges	Operating temperature	-40 °C ~ +85 °C
	Storage temperature	-40 °C ~ +85 °C
Humidity		90 %
I/O-isolation voltage		1 kVdc
Case material		KS D 3512 SPCC, t=0.5
Case Surface Treatment		Nickel Plating KS D 8302 1Class 1Grade
Size		34.0(W)×20.0(D)×12.5(H), (mm)
Weight		25 gram Max.

# KOREA KYEONGWI ELECTRONICS

DC-DC CONVERTER AR10S-2805

## 4. Case Dimension

Unit : mm

Top View

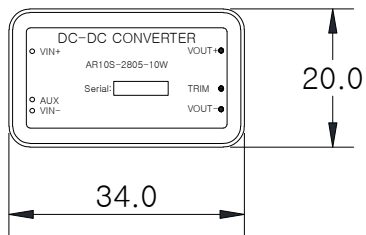

Bottom View

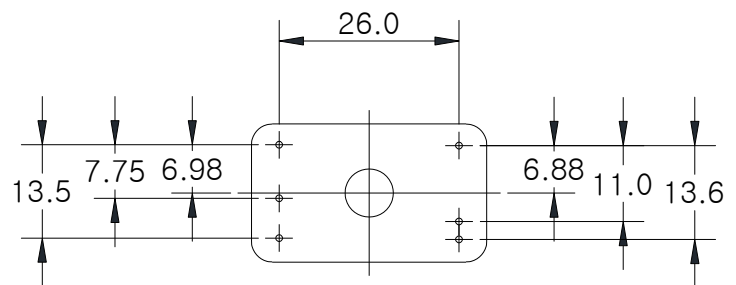

Front View

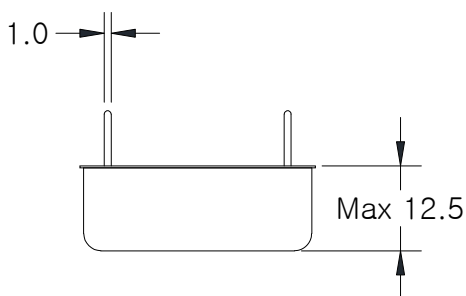

Side View

